

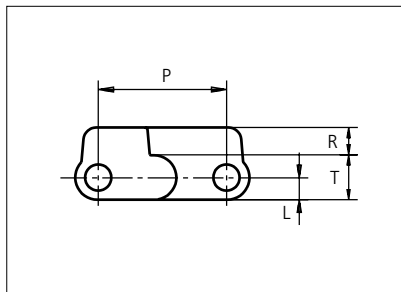

Plastic Modular Belt

Series **uni SNB** Type **M2 34% Rib**



Straight running belt
 Nominal pitch: 25.4 mm (1.00 in)
 Surface type: Rib Top
 Surface opening: 34%
 Backflex radius: 30.0 mm (1.20 in)
 Pin diameter: 5 mm (0.20 in)

Belt material & color	POM-SLF B	PP B	mm	in		mm	in	
			P (Nominal)	25.4	1.00	R	5.5	0.22
Pin material & color	PP B		L	4.4	0.17	T	8.8	0.35

Non standard material and color: See uni Material and Color Overview.

Alternative pin and lock materials: Pin: PA6.6 **B** SS304

Endlock: PP **B**

Lockpin: PP **W** PBT **LG** PA6.6 **D** **N** PE **N**

Belt width		Permissible tensile force (Belt/pin material)				Belt weight (Belt/pin material)				*Min. No. drive sprocket per shaft	Number of wear strips (Min. No.)	
		POM-SLF/PP		PP/PP		POM-SLF/PP		PP/PP			**Carry (pcs)	**Return (pcs)
mm	in	N	lbf	N	lbf	Kg/m	lb/ft	Kg/m	lb/ft			
77	3.0	1810	407	1155	260	0.5	0.33	0.3	0.22	2	2	2
153	6.0	3596	808	2295	516	1.0	0.65	0.7	0.44	2	2	2
229	9.0	5382	1210	3435	772	1.4	0.97	1.0	0.66	2	2	2
305	12.0	7168	1611	4575	1028	1.9	1.29	1.3	0.88	3	3	2
381	15.0	8954	2013	5715	1285	2.4	1.61	1.6	1.10	3	3	2
457	18.0	10740	2414	6855	1541	2.9	1.93	2.0	1.32	4	4	2
533	21.0	12526	2816	7995	1797	3.4	2.26	2.3	1.54	4	4	2
609	24.0	14312	3217	9135	2054	3.8	2.58	2.6	1.76	5	5	3
685	27.0	16098	3619	10275	2310	4.3	2.90	2.9	1.98	5	5	3
761	30.0	17884	4020	11415	2566	4.8	3.22	3.3	2.20	6	6	3
837	33.0	19670	4422	12555	2822	5.3	3.54	3.6	2.42	6	6	3
913	35.9	21456	4823	13695	3079	5.8	3.87	3.9	2.64	7	7	4
989	38.9	23242	5225	14835	3335	6.2	4.19	4.3	2.86	7	7	4

Additional standard belt widths are available in steps of 76.1 mm (3.00 in). Additional non-standard belt widths are available in steps of 12.7 mm (0.50 in).

1979	77.9	46507	10455	29685	6673	12.5	8.38	8.5	5.72	14	14	7
------	------	-------	-------	-------	------	------	------	-----	------	----	----	---

Additional standard belt widths are available in steps of 76.1 mm (3.00 in). Additional non-standard belt widths are available in steps of 12.7 mm (0.50 in).

2969	116.9	69772	15685	44535	10011	18.7	12.57	12.8	8.58	20	20	10
------	-------	-------	-------	-------	-------	------	-------	------	------	----	----	----

General belt tolerance is +0/-0.4% at 23°C/73°F and 50% RH. For exact belt width contact Customer Service. Non standard belt width on request.

*Max. Load per Drive Sprocket. Belt material: POM-D 1400 N (315 lbf), PP 1100 N (247 lbf).

**Max. Spacing between wear strips, Carry: 152 mm (6 in); Return: 304 mm (12 in).

= Single Link



STANDARD

STRAIGHT RUNNING

PITCH 25.4 MM/1.00 IN

Accessories

Finger Plates

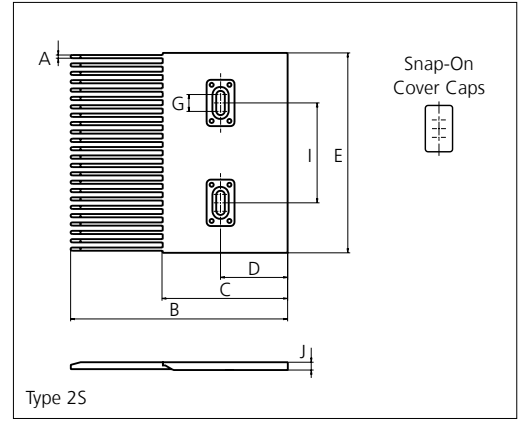
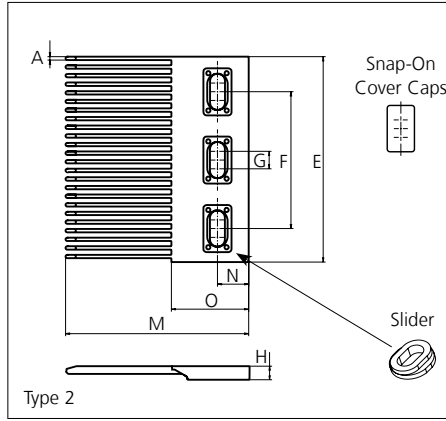
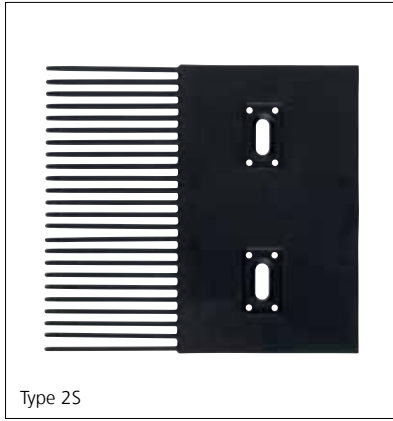

Type	Material & color	A		B		C		D		E		F			
		mm	in	mm	in	mm	in	mm	in	mm	in	mm	in		
Single Sided	POM-EC K	2.5	0.10	165.0	6.50	95.0	3.74	51.0	2.01	152.1	5.99	100.0	3.94		
Single Sided															
		G		H		I		J		M		N		O	
		mm	in	mm	in	mm	in	mm	in	mm	in	mm	in	mm	in
		12.0	0.47	10.3	0.41	76.0	3.00	6.0	0.24	135.0	5.31	23.0	0.91	57.0	2.24

All uni-chains belt systems are available in a raised rib version that can be supplied with matching finger plates also called combs. The finger plates are supplied with cover caps which can be attached when the finger plate has been installed. The cover caps can be removed by using a screwdriver that can be inserted between the cover and finger plate. In order to adjust to belt width variations caused by temperature fluctuations, a slider facilitates the sideways movement of the finger plates.

Non Standard material and color: See uni Material and Color Overview.

Sprocket

No. of teeth	Bore size													Overall diameter		Pitch-diameter		Hub-diameter		A-dimension		B-dimension		Single row/Two way	Double row/Two way	Machined	
	Pilot Bore	Bore size																								Molded	Machined
		mm	in	0.75	0.78	0.98	1.00	1.18	1.25	1.50	1.57	2.36	2.50	3.54	mm	in	mm	in	mm	in	mm	in	PA6 LG	PA6 N			
Z10	x					●	●	●	■	●				86.0	3.39	82.2	3.24	65.0	2.56	34.7	1.37	50.9	2.00	x		x	
Z12	x					●	●	●	■	●				103.2	4.06	98.1	3.86	65.0	2.56	43.0	1.69	58.9	2.32	x		x	
Z18	x						●	●	■	●				151.9	5.98	146.3	5.76	65.0	2.56	67.6	2.66	83.0	3.27	x		x	
Z18	x													151.9	5.98	146.3	5.76	120.0	4.72	67.6	2.66	83.0	3.27	x		x	
Z19	x						●	●	■	●				160.0	6.30	154.3	6.07	65.0	2.56	71.7	2.82	87.0	3.43	x		x	
Z19	x													160.0	6.30	154.3	6.07	120.0	4.72	71.7	2.82	87.0	3.43	x		x	
Z20	x						●	●	■	●				168.2	6.62	162.4	6.39	65.0	2.56	75.8	2.98	91.0	3.58	x		x	
Z20	x													168.2	6.62	162.4	6.39	120.0	4.72	75.8	2.98	91.0	3.58	x		x	

■ Molded sprocket

● Molded sprocket

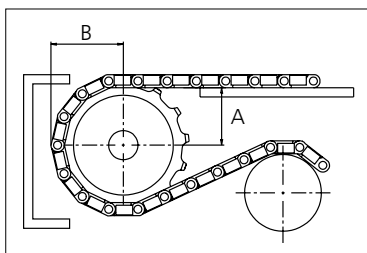
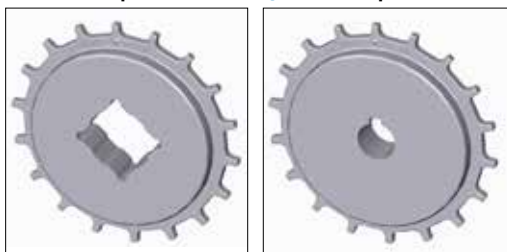

Other sprocket sizes are available upon request.

Two-part sprocket are available upon request.

Round bores are always delivered with keyway.

Other bore sizes are available upon request.

uni Retainer Rings: See uni Retainer Ring data sheet.

Width of tooth = 6.0 mm (0.24 in)

Width of sprocket = 25.0 mm (0.98 in)

Max load per sprocket shown does not take bore size into account.

Please also ensure that sufficient size shaft is chosen for corresponding load.

For correct sprocket position: See uni Assembly Instructions for uni SNB.

For more detailed sprocket information, contact Customer Service.

Non standard material and color: See uni Material and Color Overview.



Conveyor Belts



Seamless Belts



Modular Belts



Timing Belts



Transmission Belts



Fabrication & service

Expert advice, quality solutions and local service for all your belting needs
www.ammeraalbeltech.com

Ammeraal Beltech Modular A/S
Hjulmagervej 21
DK-7100 Vejle

T +45 7572 3100
F +45 7572 3348
admin@unichains.com
www.unichains.com

This information is subject to alteration due to continuous development. Ammeraal Beltech will not be held liable for the incorrect use of the above stated information. This information replaces previous information. All activities performed and services rendered by Ammeraal Beltech are subject to general terms and conditions of sale and delivery, as applied by its operating companies.